

HabasitLINK[®]

M2540 Radius Flush Grid 1"



Your Source For Habasit
Belting And Chain

www.StilesEnterprises.com • 1-800-325-4232

Description

- For radius and straight conveying (collapse factor 2.2)
- 35% open area; 53% open contact area; largest opening 6x12.5 mm (0.24"x0.49")
- Excellent for cooling and draining
- Easy to clean
- Food approved materials available
- Rod diameter 5 mm (0.2")

Available accessories

- Flights
- Sideguards
- Hold down devices
- GripTop modules
- Lane divider

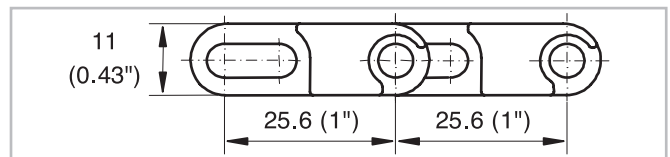
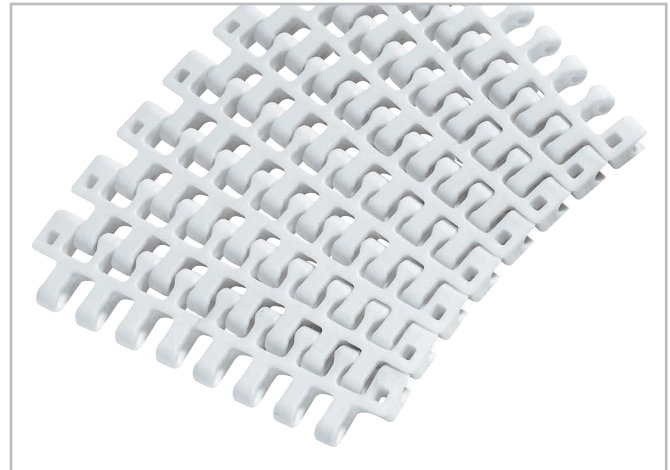

Belt data

Belt material			PP		POM +JM	PA +US	PA
Rod material			POM	PA			
Nominal tensile strength F' _N straight run	N/m		19000	19000	27000	25000	25000
	lb/ft		1300	1300	1850	1713	1713
Nominal tensile strength F' _N in curve ⁽¹⁾	N		1000	1000	1500	1300	1300
	lbf		225	225	338	293	293
Temperature range	°C		5 - 93	5 - 105	-40 - 93	-46 - 116	-46 - 130
	°F		40 - 200	40 - 220	-40 - 200	-50 - 240	-50 - 266
Temperature maximum (short-term)	°C					135	160
	°F					275	320
Belt weight m _B	kg/m ²		4.7	4.7	7.0	6.0	6.0
	lb/sqft		0.96	0.96	1.44	1.23	1.23

⁽¹⁾ For b₀ > 300 mm (12") higher values admissible. Refer to LINK-SeleCalc

Diameter of idling rollers (minimum)		Diameter of support rollers (minimum)		Diameter for gravity take-up and center drive rollers (minimum)		Backbending radius for elevators without sideguards or hold down devices (minimum)		Backbending radius for elevators with sideguards or hold down devices (minimum)	
mm	inch	mm	inch	mm	inch	mm	inch	mm	inch
40	1.6	50	2	100	4	150	6	250	10

Use the largest possible backbending radius for elevators with side guards or hold down devices.